

- Junct.
- Cross Section
- Brdg/Culv
- Inline Structure
- Lateral Structure
- Storage Area
- Storage Area Conn.
- Pump Station
- HTab Param.
- View Picture

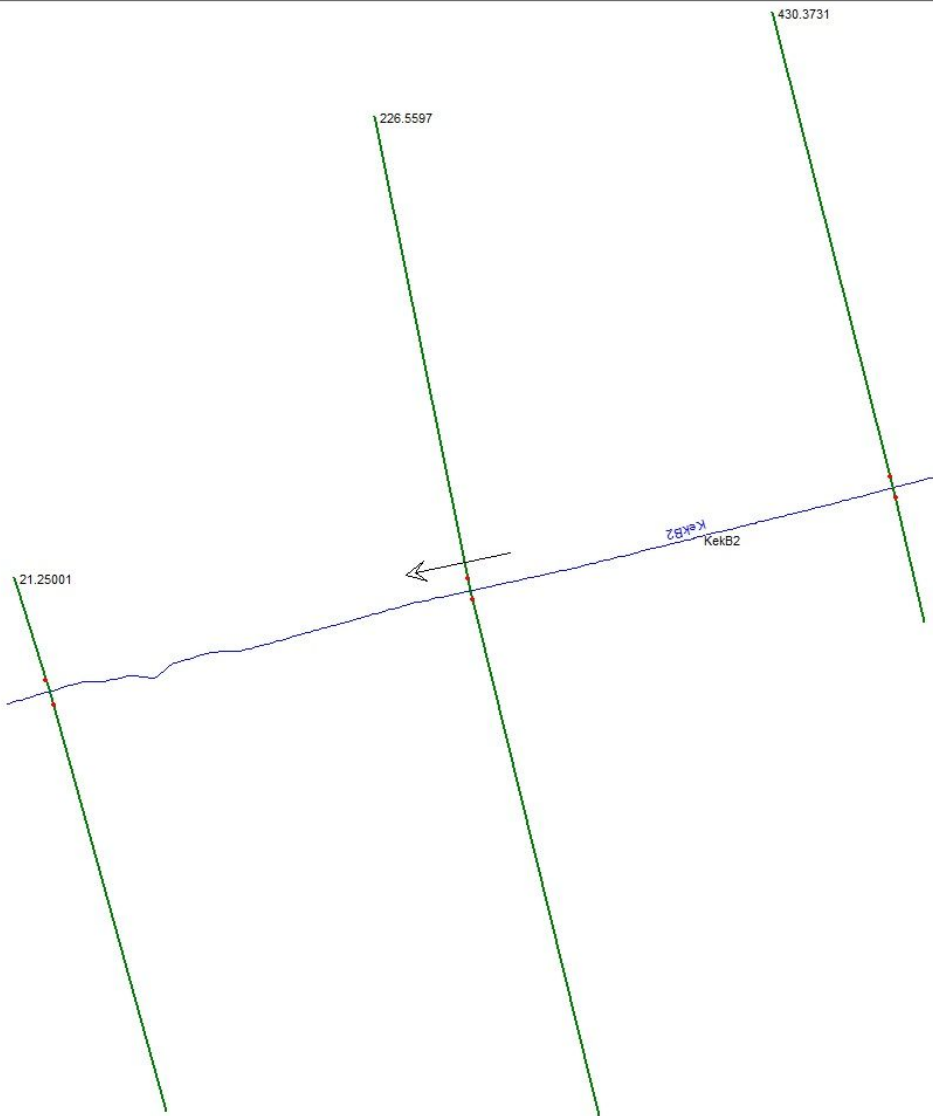

River: KekB2 Apply Data

Reach: KekB2 River Sta.: 21.25001

Description

Del Row Ins Row

Cross Section Coordinates

Station	Elevation
1	0
2	2.72
3	3.11
4	7.72
5	8.6
6	11.69
7	12.23
8	13.44
9	14.36
10	16.82
11	16.95
12	17.5
13	18.82
14	20.6
15	21.88
16	24.83
17	27.78
18	29.43
19	30.46
20	33.29
21	35.09
22	36.31
23	36.93
24	38.74
25	39.4
26	40.09
27	42.94
28	43.44
29	44.76
30	46.15
31	46.71
32	48.32
33	49.37
34	49.78
35	50.2
36	50.28
37	54
38	54.9
39	55.9
40	57.9
41	58.9
42	62.07
43	62.45
44	65.19
45	66.13
46	66.25
47	66.84
48	67.81
49	69.89
50	71.03
51	71.34
52	73.49
53	74.82

Downstream Reach Lengths

LOB	Channel	ROB
0	21.25	0

Manning's n Values

LOB	Channel	ROB
0.06	0.05	0.06

Main Channel Bank Stations

Left Bank	Right Bank
50.2	62.07

Cont'Exp Coefficient (Steady Flow)

Contraction	Expansion
0.1	0.3

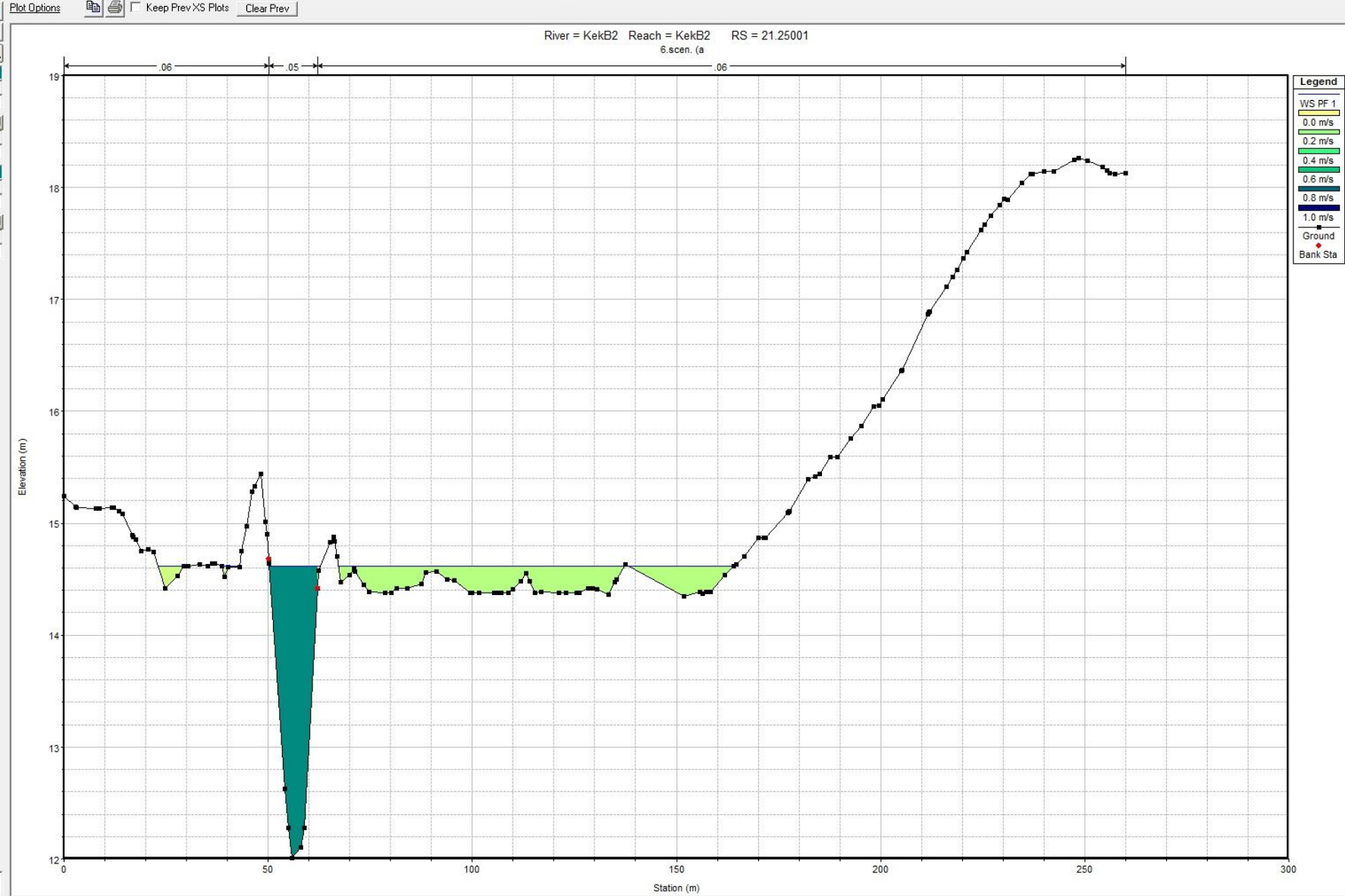

Select river station for cross section editing.

River: KekB2 Apply Data

Reach: KekB2 River Sta.: 226.5597

Description

Del Row Ins Row

Cross Section Coordinates

Station	Elevation
1 0	19.03
2 0.17	19.04
3 6.33	18.9
4 7.21	18.88
5 7.75	18.88
6 7.83	18.88
7 12.48	18.87
8 13.61	18.82
9 15.28	18.62
10 16.27	18.51
11 17.71	18.4
12 19.17	18.57
13 23.15	18.74
14 24.3	18.66
15 25.29	18.67
16 25.6	18.67
17 25.71	18.67
18 31.8	18.79
19 33.4	18.81
20 34.28	18.8
21 36.85	18.78
22 40.3	18.72
23 41.81	18.7
24 43.7	18.63
25 45.38	18.62
26 47.75	18.63
27 48.13	18.63
28 52.52	18.61
29 55.48	18.6
30 55.87	18.59
31 63.34	18.57
32 63.43	18.57
33 63.55	18.57
34 63.9	18.55
35 70.21	18.39
36 72.11	18.39
37 73.97	18.35
38 77.97	18.19
39 79.16	18.13
40 81.82	18.13
41 87.24	18.13
42 88.1	18.12
43 89.26	18.2
44 90.52	18.24
45 90.76	18.26
46 91.09	18.1
47 91.42	18.24
48 93.4	18.24
49 96.01	18.12
50 97.14	18.04
51 98.67	17.85
52 102.21	17.86
53 103.76	17.88

Downstream Reach Lengths

LOB	Channel	ROB
205.31	205.31	205.31

Manning's n Values

LOB	Channel	ROB
0.06	0.05	0.06

Main Channel Bank Stations

Left Bank	Right Bank
221.02	231.13

Cont'n Exp Coefficient (Steady Flow)

Contraction	Expansion
0.1	0.3

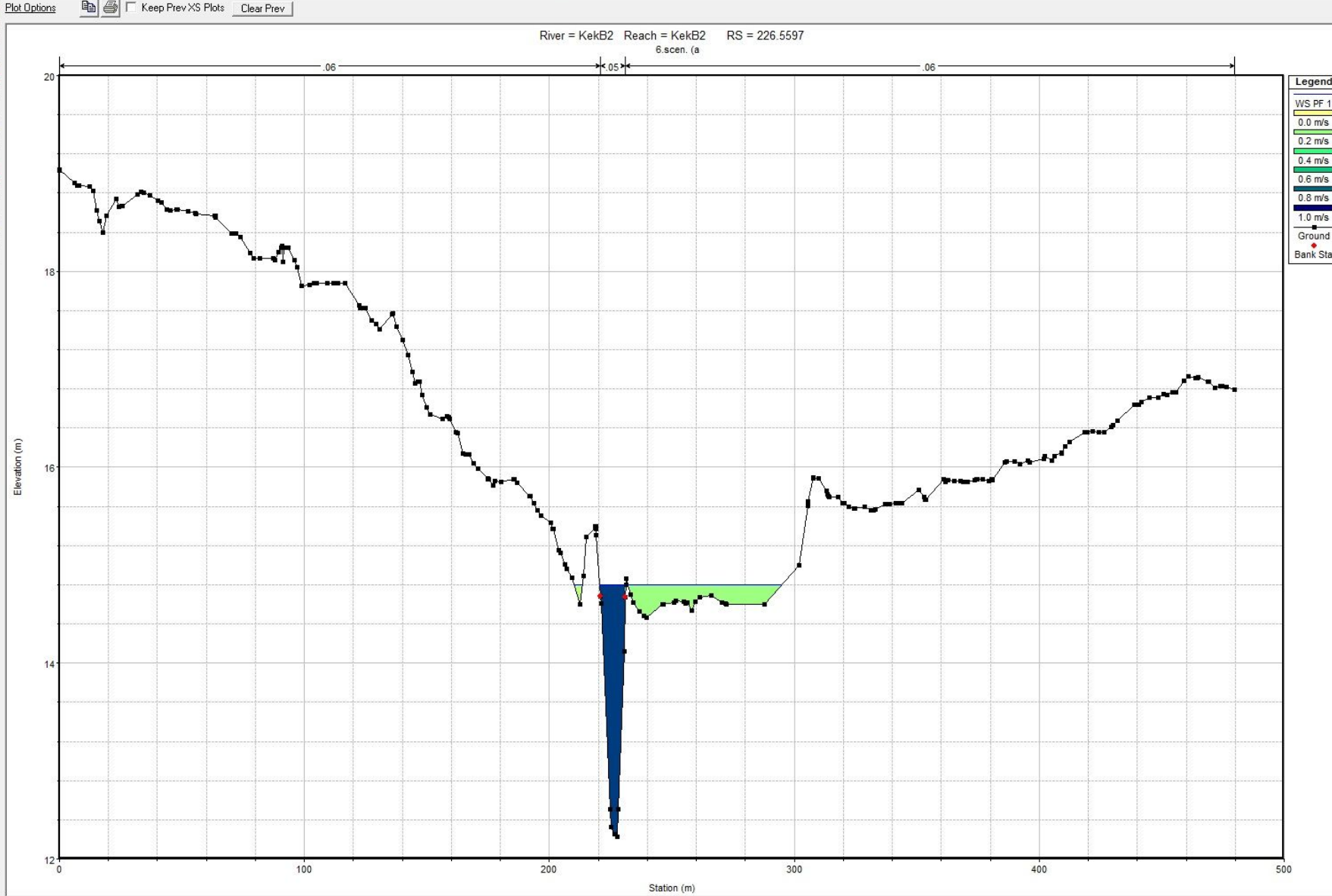

River: KekB2 Apply Data

Reach: KekB2 River Sta.: 430.3731

Description

Del Row Ins Row

Cross Section Coordinates

Station	Elevation
1	0
2	1.13
3	1.85
4	2.57
5	3.9
6	5.76
7	7.05
8	10.95
9	11.94
10	12.56
11	15.22
12	16
13	18.39
14	18.95
15	19.2
16	23.17
17	26.05
18	26.86
19	31.12
20	31.43
21	31.66
22	33.91
23	34.98
24	35.76
25	36.23
26	39.27
27	40.3
28	41.78
29	43.22
30	44.7
31	46.12
32	49.72
33	51.16
34	53.29
35	55.8
36	57.3
37	57.99
38	60.32
39	60.96
40	62.26
41	63.3
42	63.97
43	65.16
44	67.76
45	68.86
46	71.32
47	72.68
48	73.7
49	74.22
50	75.04
51	77.12
52	78.8
53	81.76

Downstream Reach Lengths		
LOB	Channel	ROB
203.81	203.81	203.81

Manning's n Values		
LOB	Channel	ROB
0.06	0.05	0.06

Main Channel Bank Stations	
Left Bank	Right Bank
224.36	234.91

Cont'Exp Coefficient (Steady Flow)

Contraction	Expansion
0.1	0.3

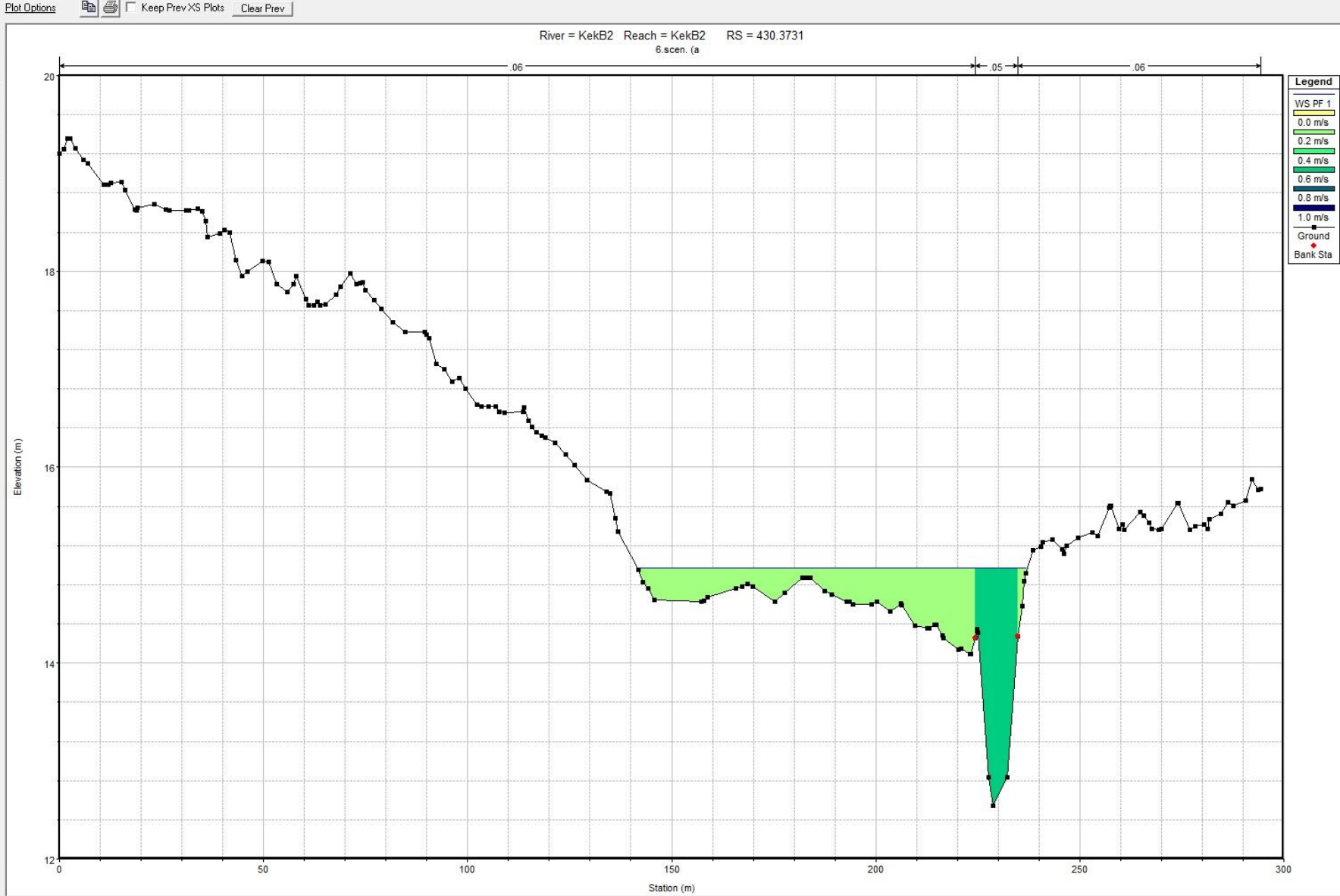

Enter/Edit Number of Profiles (25000 max):

Locations of Flow Data Changes

River:

Reach: River Sta.:

Flow Change Location

River	Reach	RS	PF 1
1 KekB2	KekB2	430.3731	16.72

Profile Names and Flow Rates

Steady Flow Boundary Conditions

Set boundary for all profiles
 Set boundary for one profile at a time

Available External Boundary Condition Types

Selected Boundary Condition Locations and Types

River	Reach	Profile	Upstream	Downstream
KekB2	KekB2	all		Normal Depth S = 0.00077

Enter to accept data changes.